



CONGRESS SEEFELD SETS NEW IMPULSES 2024



© Region Seefeld, Sebastian Marko

SEEFELD SPORTS ARENA

MÖSERERSTRASSE 632A, 6100 SEEFELD IN TIROL

+ 43 (0) 664 884 396 80/ ARENA@SEEFELD-SPORTS.AT

WWW.WM-SPORTANLAGEN.AT

Region Seefeld – Tirols Hochplateau

Power Source: for incentives and conventions



Seefeld – Tirols Hochplateau comprising five mountain village towns, spreads across a geologically unique high alpine plateau at 1,200 meters altitude which opens wide towards the south. Surrounded by Alpenpark Karwendel, largest nature reserve in the Eastern Alps, nature preserve Wildmoos and the Wetterstein Massif, the region is an ideal setting for incentives, conferences, seminars and conventions – far removed from the hectic pace of cities.

In the heart of the Alps

Central location:

- Appx. 20 min. from Airport Innsbruck
- Appx. 1.5 hrs from international Airport Munich
- Train station at town center (fast train-stop)
- Quick access to motorways in all directions of the compass

Perfect infrastructure

An outstanding hotel landscape, mainly in 4-star and 5-star categories; a perfect communal infrastructure at the Olympia Sport and Congress Centre and WM-Hall Seefeld; coupled with an inspired fountain of ideas from our conference and incentive specialists to help you create your own perfect company event.

Culinary highlights

A bevy of restaurants and inns will provide the suitable backdrop for all your events, regardless whether you seek a rustic hut for 40 – 100 people where genuine Tyrolean specialties are prepared and served, or choose to follow the path of Gault-Millau award-winning restaurants, we have the solution for every taste and culinary craving.

Nature makes the best programmes

The possibilities for your background programmes are nearly unlimited, since their source is pure nature. You can relax, savour the scenery, liberate your mind for new endeavors. It would surely not be the first time innovative concepts were born while cross-country skiing, alpine skiing, hiking or on the golf course. Our outdoorpros will put together team building packages to provide every level of adventure in the region.



© Region Seefeld



© Region Seefeld

WM-Halls Seefeld

The World Championship halls are perfectly suited for large-scale events. The nordic ski stars, the folk music scene and the world tourism games have all held their events in these halls. Regardless whether for presentations, concerts, trade fairs or exhibitions, the WM-Hall in Seefeld provides optimum, extremely flexible spaces for up to 2.500 people.

Seating possibilities & capacities:

Room	Size	Cinema	Parliament	Cocktail	Banquet	Price per day
Hall 1	2.500 m ²	on request	on request	on request	on request	on request
Conference room	60 m ²	50	30			Euro 100,-

Above prices do not include 20% VAT. Hall 1 can be divided in half with a curtain, resulting in 2 rooms.

Congress technology

Basic technical equipment is installed, according to the requirements of each event.

Congress catering

In the same building is the Restaurant Casa Padel, which could help you to organise an adequate catering. The restaurant loungis has the catering privilege in the WM-Hall.

Parking

There are several parking areas in the immediate vicinity of the WM Halls. Depending on the size of the event, additional parking spaces can be organised.



Basic building at the foot of the Toni Seelos Jumping hills

This location is an ideal venue for “conferences in the heart of nature”.

Since 2005, a highly attractive alternative for smaller events with an unusual flair has been on offer: in the newly erected building at the foot of the Toni Seelos Ski Jump, you can hold conferences in the very center of winter sports activities, with views of the imposing ski jump and stadium arena, as well as the entrance to the cross-country ski trails.

Seating possibilities & capacities:

Room	Size	Cinema	Parliament	Cocktail	Price per day
Toni Seelos Room (VIP)	135 m ²	100	60	140	Euro 250,-
Media-Lounge	125 m ²	100	60	140	Euro 180,-
Conference room	60 m ²				Euro 100,-

Above prices do not include 20% VAT.

Congress technology

The technical equipment is selected and installed according to the individual requirements of each event. The price of the equipment is adjusted to the desired equipment selected by the event organiser. Personal technical supervision by our personnel also available as an option.

Congress catering

In the basic building, external catering service is possible. We would be pleased to assist you in selecting a local caterer. Prices on request.

Parking

In the area of the Seefeld Sports Arena are parking spaces for participants and performers for your events.



Activities and Services

The range of amenities which guests to Seefeld value so highly are a top priority factor in the selection of a conference venue. The sports and leisure activities on offer are numerous: golf, hiking, mountain biking and lots more in summertime; cross-country skiing, alpine skiing and many additional possibilities in wintertime. Outdoor specialists and event professionals on location provide a flexible and customdesigned shape to your event and its background programme.



© WM-Sportanlagen



© Region Seefeld, Stephan Elsler

Below a few ideas for your background programme in Seefeld:

- Cross-country skiing, biathlon and ski-races
- Fun-Olympics
- Teambuilding activities
- Segway tours, E-Bike tours
- Summer biathlon with ski rollers
- Golf tournaments, snow-golf tournaments, snowshoe walks
- Lama tours, canyon adventure
- Curling and ice-skating fun, horse and trap rides
- Paintball, hut evenings, visit the casino Seefeld
- Product tastings of local items

The incentive and congress department of the Region Seefeld – Tirols Hochplateau can help organise fun outdoor activities for your group or event.



© Region Seefeld, Moritz Klee



© Region Seefeld, Stephan Elsler

Olympia Congress Center



The event rooms at the Olympia Congress Center will win your acclaim: not only through the perfect technical equipment, but also the individualized, personal care which accompanies it to create and maintain an extraordinary ambience. Cozy wood paneling, lots of daylight, perfect lighting and immense flexibility in setting up your rooms, as well as ample possibilities to extend and expand the spaces into the foyers ensure you every imaginable flexibility. In summer you can also rent our sports field for exhibitions. As a special offer, the sport and congress Center also has its own state-of-the-art cinema which can be utilised as an integral part of your event.

Seating possibilities & capacities:

Room	Size	Cinema	Parliament	U-Shape	Cocktail	Price per day
Hall Olympia	300 m ²	250	130	40-60	350	Euro 920,-
Hall Tirol	75 m ²	50	30	15	85	Euro 190,-
Hall Seefeld	75 m ²	50	30	15	85	Euro 190,-
Hall Seefeld/ Tirol	150 m ²	100	60	30	175	Euro 380,-
Sports Field	1800 m ²					Euro 300,-
Cinema	200 m ²	148				on request

Prices do not include 20% VAT.

Included in the price are seating arrangements, technical equipment and cleaning.

Congress technology

JBL-Loudspeakers, 2x500 Watt Activboxes, HD Laser Projector with 15.000 Lumen, 16 channel console, radio microphones, stand-up microphones, podium microphones, Headsets (3), CD-Player, Blu-ray- & DVD Player, presenter mouse, notebook, large screen (5x6 meters), internet access (300 Mbit/s) for both auditoriums and Olympia auditorium foyer. Personal technical supervision by our personnel also available as an option.

Congress catering

Meals and coffee snacks for convention participants can be arranged by Restaurant Olympia.

The restaurant has the catering privilege in our congress Center.

Parking

Olympia Congress e offers an inexpensive parking in its own underground garage (210 slots).



Floor plan

Hall Olympia, Hall Seefeld/Tirol

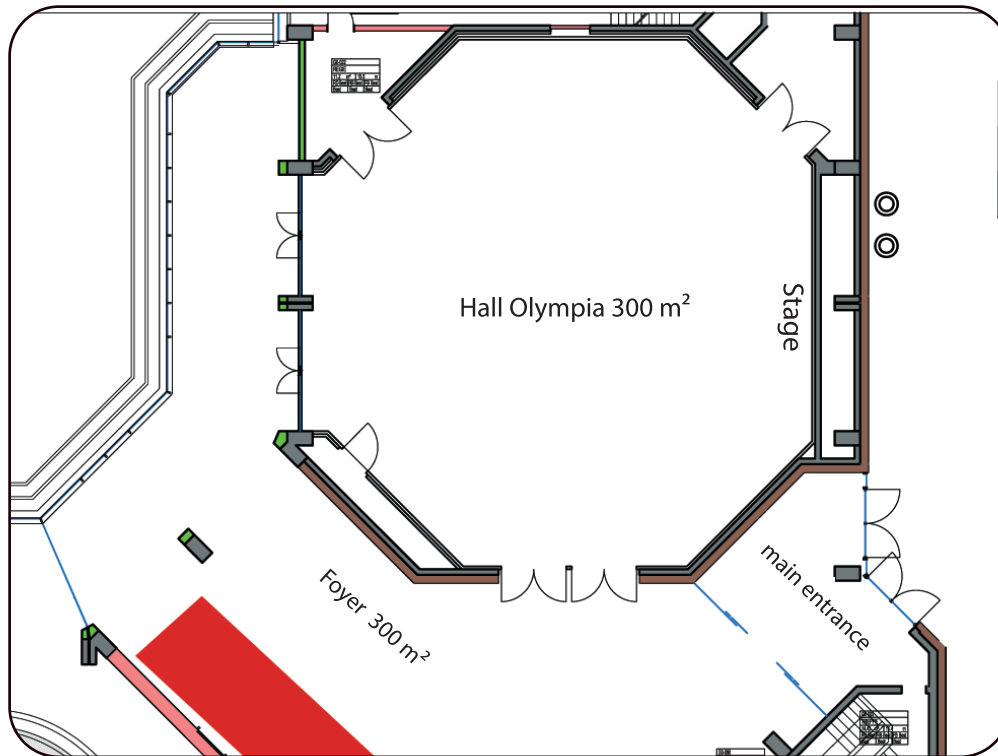

Floor plan
hall Olympia

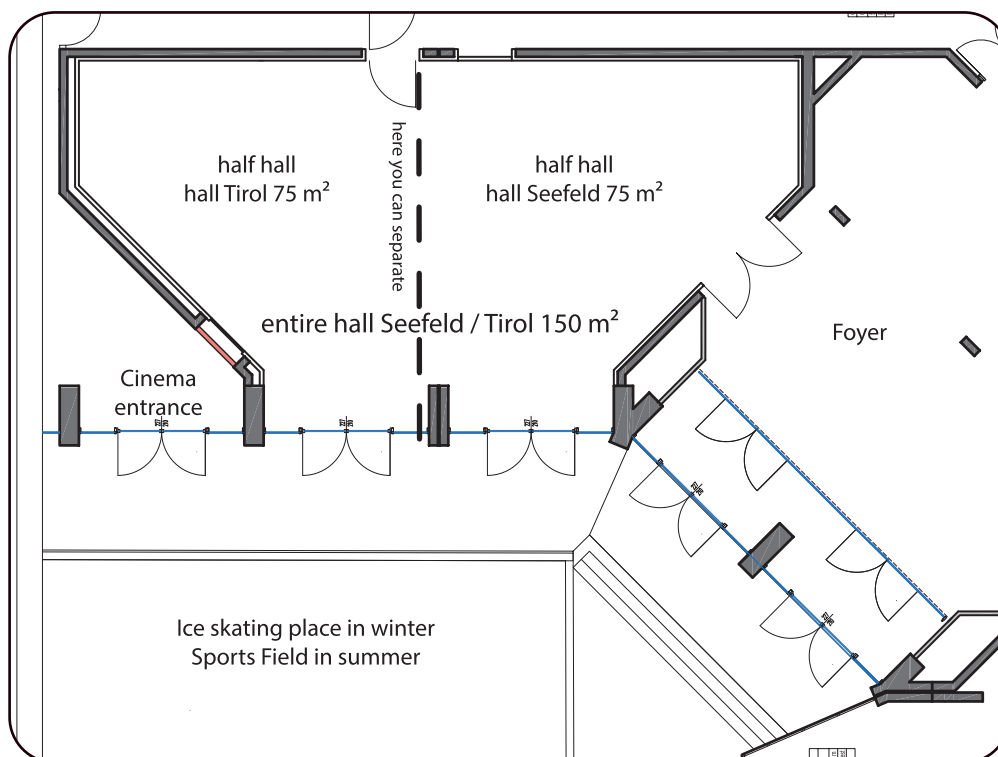

Floor plan
hall Seefeld/Tirol

Contact and Service

The congress team offers everything you need, from planning, to ongoing support measures, to finding the right partners for your concepts, to organisation of service and coatroom personnel. Comprehensive services for every event, as you require it. Together we make your event unique.

Contact

Seefeld Sports Arena
Mösererstraße 632a
A-6100 Seefeld

Tel: +43(0) 664/ 884 396 80
E-Mail: arena@seefeld-sports.at

www.wm-sportanlagen.at



© Region Seefeld, Stephan Elsler



© Region Seefeld, Stephan Elsler